

ADJUSTABLE RAIL SHOE INSTRUCTIONS

How to use the Trak-Star Adjustable Rail Shoe

- 1) Loosen the tightening handle, not all the way just a $\frac{1}{4}$ or $\frac{1}{2}$ turn should do the trick.
- 2) Remove pin from the slide.
- 3) Align the rail size numbers on the side of the slide to the number on the shoe. Make sure the line next to the number on the slide, matches up with the line next to the number on the shoe.
- 4) Replace pin in the aligned holes through the slide and the shoe directly over the numbers your currently using.
- 5) Tighten the handle back down to secure the shoe in place before drilling.
- 6) Repeat this process for the other shoe.

Notes:

- A) Replace the 4-Point knobs with the tightening handles to secure the shoes in place. This will allow you to adjust the shoe without removing it from the drill.
- B) Once tight the end of the handle may be facing toward the front of the drill. If that happens pull straight out on the handle and rotate it towards the motor, if done correctly doing this should not affect the tightness of the shoe.
- C) Make sure to adjust both the left and the right shoes before drilling.
- D) There are numbers on both sides of the slide, look at both sides when trying to find size of rail you're cutting.
- E) There is a left and a right shoe, be sure the numbers are facing away from the drill when installing.

AREA Sizes Included:

- | | |
|-----------|-----------|
| • 100 | • 131 |
| • 110 | • 132 |
| • 112 | • 133 |
| • 115/119 | • 136/141 |
| • 130 | • 140 |

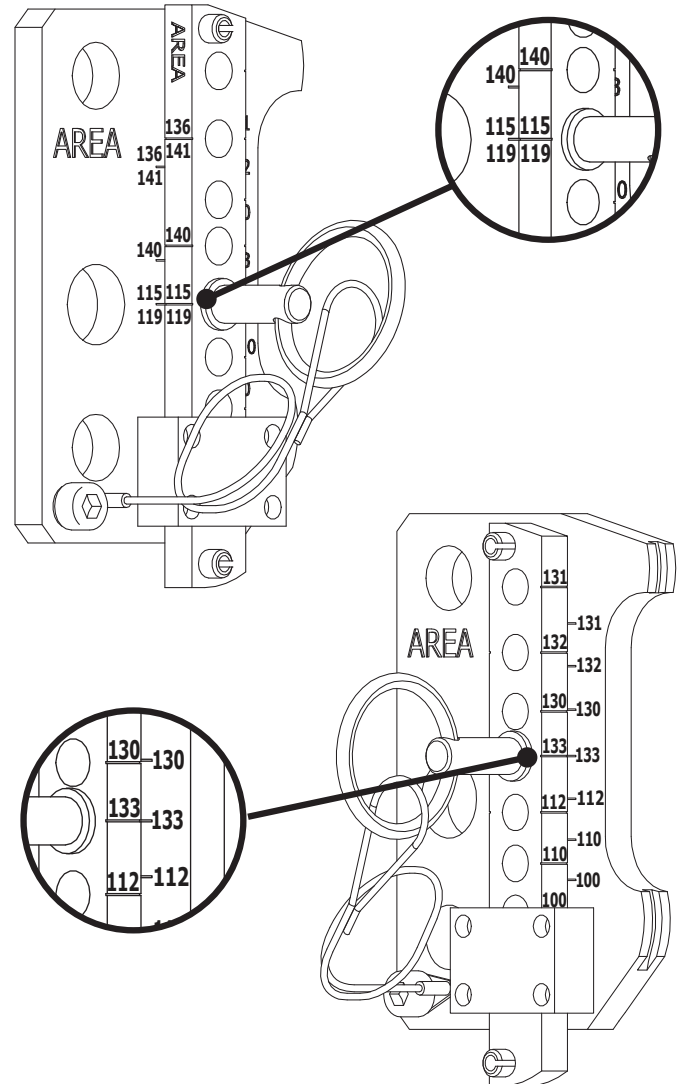

Any further questions regarding
this product please contact
Trak-Star at: 866-245-3745



Part No: 08620 (Pair of Shoes)

Hougen Manufacturing, Inc
3001 Hougen Dr • Swartz Creek, MI 48473 USA
866-245-3745 • www.trak-star.com